

Single Acting Rod Wiper Seal Imperial PWK

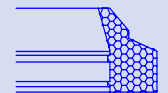
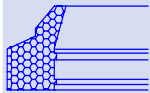

Design

Claron **Style PWK** Rod wiper is designed to remove potential system contaminants from a reciprocating rod during the negative stroke. It is classified as a medium to heavy duty wiper and is precision moulded in 92° shore Polyurethane and offers an alternative, single-acting, design for PWE housings. The wiper is machine trimmed to provide a precise wiping lip. The design incorporates ribs on the heel working face to ensure concentricity and stability.

Operating Conditions

Temp. range	-40°C to 110°C
Max Linear Speed m/sec	3.0

Optimum service conditions are affected by temperature, speed and surface finish.
Refer to Appendix 1 for further information.

Continuous operating temperature for various Fluids

AU Polyurethane		
DIN	Hydraulic Fluid Description	°C
H	Mineral oil without additives	100
H-L	Mineral Fluid with anti corrosion and anti ageing additives	100
H-LP	Mineral oil as HL plus additives reducing wear, raising load	100
H-LPD	Mineral oil as H-LP but with detergents and dispersants	100
H-V	Mineral oil as H-LP plus improved viscosity temp.	100
HFA E	Emulsions of mineral oil in water. Water content 80-95%	40
HFA S	Synthetic oil in water. Water content 80-95%	40
HFB	Emulsions of water in mineral oil. Water content 40%	40
HFC	Aqueous polymer solutions. Water content 35%	ns
HFD R	Phosphoric acid ester based	ns
HFD S	Chlorinated hydrocarbon based	ns
HFD T	Mixtures of HFD R and HFD S	ns
HEPG	Polyglycol based	ns
HETG	Vegetable Oil based	60
HEES	Fully synthetic ester based	60

Housing

For surface finish and recommended lead in chamfers refer to the illustration below. For housing dimensions and machining tolerances refer to the catalogue page of selected seal.
Refer to Appendix 4 for value of tolerance symbols.

Fitting

Style PWK may be deformed and fitted into a closed groove housing as shown below. For the seal to function correctly, it is important that care be taken in fitting the seal within its housing.
For a detailed checklist, refer to Appendix 3.

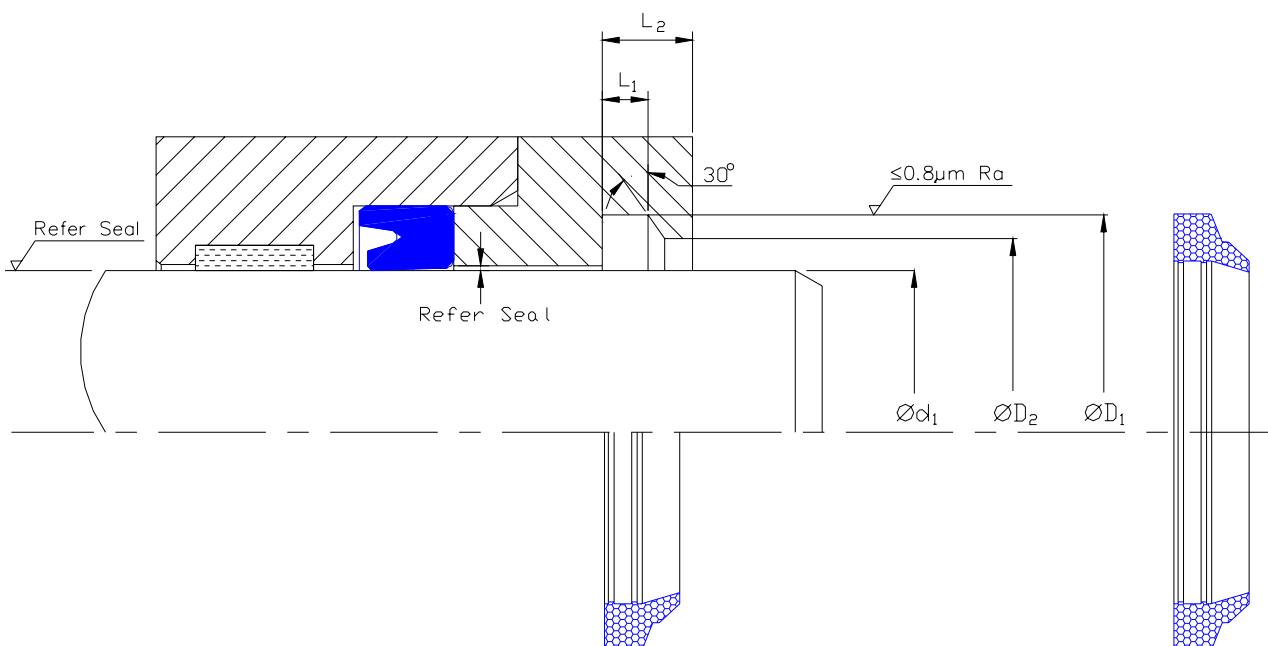

PWK

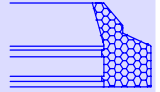
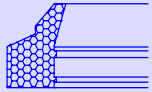

Nominal Dimensions & Machining Tolerances

Claron Part Number	Refer Seal Selection Ød ₁	+0.005 -0.000 ØD ₁	+0.005 -0.000 ØD ₂	+0.005 - 0.000 L ₁	Nominal L ₂
PWK 1000	1.000	1.385	1.082	0.195	0.343
PWK 1250	1.250	1.635	1.332	0.195	0.343
PWK 1375	1.375	1.760	1.457	0.195	0.343
PWK 1500	1.500	1.885	1.582	0.195	0.343
PWK 1500A	1.500	1.760	1.582	0.183	0.295
PWK 1750	1.750	2.135	1.832	0.195	0.343
PWK 1875	1.875	2.260	1.957	0.195	0.343
PWK 2000	2.000	2.385	2.082	0.195	0.343
PWK 2000A	2.000	2.260	2.082	0.183	0.295
PWK 2250	2.250	2.760	2.405	0.255	0.468
PWK 2500	2.500	3.010	2.657	0.255	0.468
PWK 2750	2.750	3.260	2.905	0.255	0.468
PWK 3000	3.000	3.510	3.157	0.255	0.468